

## RM-FL2 铝合金传感器

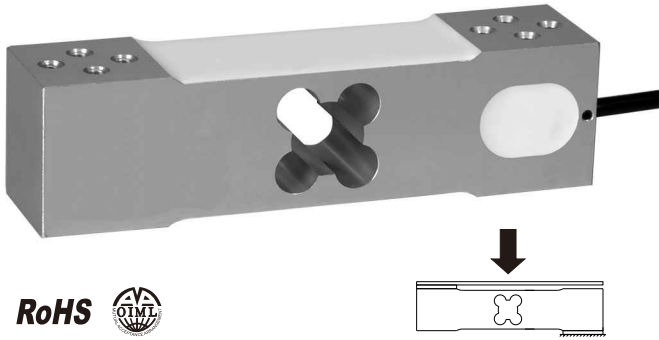

### 产品特性 Product Characteristic

铝合金结构  
Aluminum alloy.  
高精度，OIML R60 C3 认证  
High accuracy, OIML R60 approved.  
广泛用于计价秤，计数秤，平台秤等  
Mainly used for price computing scale, counting scales, platform scales etc.  
最大秤盘尺寸400x400mm  
Max. platform size: 400x400mm.

### 外形图 Appearance Picture

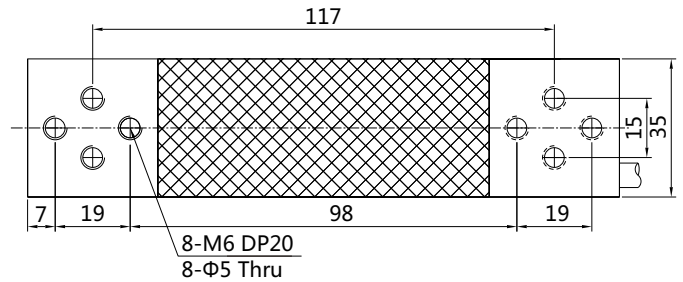
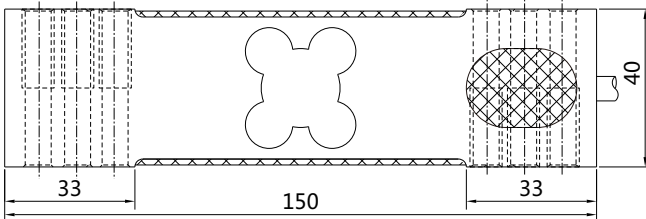

### 技术参数 Technical Parameter

载荷特性 Load Speciality	
额定载荷 Maximum Capacity	25,40,60,100,200,350 (kg)
准确度等级 Accuracy Class	C*
灵敏度 Sensitivity	2.0 ± 5% mv/v
非线性(含滞后) Nonlinearity(Included Hysteresis)	± 0.015% F.S
重复性 Repeatability	± 0.01% F.S
蠕变(30分钟) Creep(30 Min)	± 0.02% F.S
温度特性 Temperature Speciality	
温度对零点影响 Temperature Effect On Zero Balance	± 0.02% F.S/10℃
温度对灵敏度影响 Temperature Effect On Sensitivity	± 0.02% F.S/10℃
工作温度 Service Temperature Range	-30 ~ +70℃
温度补偿范围 Compensated Temperature Range	-20 ~ +60℃
机械特性 Machine Speciality	
安全承载 Safe Load Limit	150% F.S
极限承载 Lateral Load Limit	200% F.S

破坏载荷 Breaking Load	300% F.S
电气特性 Electric Speciality	
输入电阻 Input Resistance	405 ± 10Ω
输出电阻 Output Resistance	350 ± 5Ω
绝缘电阻 Insulation Resistance	≥ 5000MΩ
零点平衡 Zero Balance	± 1% F.S
推荐工作电压 Recommended Excitation	10V(DC)
最大工作电压 Maximum Excitation	15V DC
其它 Else	
材质 Construction	铝合金 Aluminum
电缆长度 Cable Length	∅5mm×1.5m *
密封等级 Protection Class	Ip65
引用标准 Citation	GB/T7551-2008 OIMLR60
接线方式 Mode Of Connection	输入+红 Input+:Red 输入-黑 Input-:Black 输出+绿 Output+:Green 输出-白 Output-:White